

**STANDARD SECTION CORNER COMMON TO SECTIONS 33 AND 34
TOWNSHIP 4 NORTH, RANGE 10 WEST, WILLAMETTE MERIDIAN
CLATSOP COUNTY, OREGON**

HISTORY:

Italic = author's notes

Record No. 1 April 15, 1892 – Manius Buchanan, GLO Deputy Surveyor with D.S. Boyakin, Charles L. Koelsche, Thomas Mitchell, William H. Bush, Frank Steinhauer and Edward Ellis in his Contract No. 584 of the exterior lines of Township 4 North, Range 10 West:
 “On steep Mt. side, Set Post 4 1/2 ft. long, 4 ins. square, 24 ins. in ground for Cor. to Sec’s. 33, 34, 3 & 4 marked T.4N. S. 34 on N.E., R.10W. S3 on S.E., T.3N.S.4 on Sw, and S. 33 on Nw. faces with 3 notches on W. & E edges from which
 a Hemlock 13 ins diam. bears N31°W 13 lks. (8.6 feet) dist. marked T.4N. R.10W. S33 B.T.,
 a hemlock 24 ins. diam. bears N.26E 42 lks. (27.7 feet) dist, marked T4N. R.10W. S.34 B.T.,
 a hemlock 9 ins. diam bears, S.42°E. 21 lks. (13.9 feet) dist. marked T.3N. R.10W. S.3 B.T., &
 a hemlock 36 ins. diam. bears S23°W. 34 lks. (22.4 feet) dist. marked T.3N. R.10W. S.4 B.T..
 Land-hilly-rising onto Mountain.”

Record No. 2 June 21, 1893 – Manius Buchanan, GLO Deputy Surveyor with Charles L. Koelsche, Hans Larsen, Christian Larsen, and Chris Olsen in his Contract No. 609 of the subdivision of Township 3 North, Range 10 West:
 “N.0°14’E Bet. Secs. 3 and 4-
 ... 79.50 (chains) Summit of E. Mt. spur 1200 ft. high
 Descend
 81.50 Intersect N. Bdy. Of township Tp. ~~1st Standard Parallel~~ - 5.50 chs. W. of Cor. to Secs. 33 and 34, which is a post 4 1/2 ft. long, 4 ins. square 24 ins. in the ground marked T.4N. R.10W. S.34 on N.E. & S.33 on Nw. faces with 3 notches on E and W. edges from which
 a hemlock 24 ins. diam. bears N26°E. 42 lks. dist. marked T.4N. R.10W. S.34 BT. &
 a hemlock 13 ins. diam. bears. N31°W. 13 lks. dist. marked T.4N. R.10W. Se 33 B.T.,
 *(marks relating to T.3N. Secs. 3 and 4 des are destroyed)
 At point of intersection is a Larch 36 ins. diam. which I mark C.C.T.3N.R.10W. on S., S. 3 on E and S.4 on W. with 3 notches on E. and W. faees sides for closing Cor. for Secs. 3 and 4;
 from which....
 Soil – loam – 1st & 2nd rate
 * I destroy the other witnesses”
Lined-out text above is directly from the record.

Record No. 3 April 6, 1960 – Wiljo Green, Engineering Tech for Oregon State Board of Forestry:
 “Sec. Cor. 3-4-33-34 T3&4N R10W
 Cor. consist of 3 Bts.
 30” Hem. N31W 13 lks. Scribes S33 vis.
 16” “ S42E 21 “ “ 10 T vis.
 “ N26E 42 “ “ R10W vis. but badly rotted.
 Metal location poster on 30” Hem. BT. Sec. line marker between 3-34 is on Hem. on the Short Sand log road 5 chains East of the cor.
 (Oregon State Board of Forestry Corner Card No. 417, Clatsop County Survey Records)

REGISTERED
PROFESSIONAL
LAND SURVEYOR

VANCE SWENSON
 OREGON
 JULY 09, 2001
 VANCE S. SWENSON
 65703 LS

RENEWS 07-01-2026

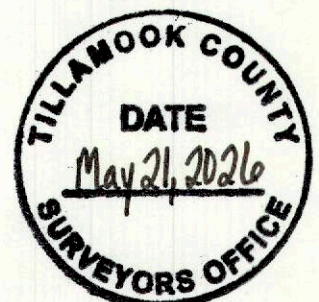

Record No. 4 February 21, 1964 – Crown Zellerbach Field Crew initials T.A., W.S.:
 "T4N R10W (map depicts standard section corner between sections 33 and 34)

Evidence:

2 BT's, Post, location tags

Photo: 62 45-5

BT Descriptions

Species	DBH	Sec	Bearing	Dist	Comments on Condition
H	16"	3	S28°E	14.5'	stump – scribed face
H	26"	33	N31°W	8.6'	stump – scribed face

Remarks:

Corner in recent clearcut, in Triangle between three large boulders.

Tag on stump west side of 24 spur. 380 ft West to corner."

(Crown Zellerbach Loose Leaf Field Book 31, Page 61, Clatsop County Survey Records)

Record No. 5 November 19, 2013 – Chris Butler, LS 86894 in survey for Longview Timberlands, LLC and Stimson Lumber Co.:

"SE corner Section 33-T4N-R10W (SC) (found corner)

Corner history

GLO (Buchanan 1891): Set post on steep mountain side and established the following accessories:

- 13" hemlock N31°W 8.58'
- 24" hemlock N26°E 27.72'
- 9" hemlock S42°E 13.86' (destroyed 1893)
- 36" hemlock S23°W 22.44' (destroyed 1893)

Found evidence (2013)

This survey found the following original bearing trees:

- 25" hemlock stump in poor condition with scribe visible on open face N36°W 8.65' to face
- 22" hemlock stump with chopped out face S36°E 14.0' to face

This survey set a Bernsten G3250 (1" x 30") aluminum pipe with 2 1/2" aluminum cap stamped as shown (Butler Surveying Inc. T4N R10W SC S33 S34 2013 OR 86894 PLS WA PLS 36792) at the position ascertained from the found original bearing trees and established to following accessories:

- Scribed X in 3' x 3' rock S86°W 11.10'
- 14" hemlock scribed [T4N R10W S 34 BT] N68°E 10.47'
- 12" hemlock scribed [T4N R10W S 33 BT] N15°W 13.98'
- Steel T-post 1.0' North of corner

(CS# 12931, Clatsop County Survey Records)

EVIDENCE – MONUMENTION.

On January 22, 2026, we found a 1" x 30" aluminum pipe with a triangular tip and a 2-1/2" aluminum cap stamped "Butler Surveying Inc. T4N R10W SC S33 S34 2013 OR 86894 PLS WA PLS 36792" above ground 6". In its place, we set a 2" galvanized iron pipe made 25" long by bending the bottom 5" flares upward to account for bedrock at a depth of 24", with a 3-1/4" brass cap stamped "Clatsop County Surveyor T4N R10W S33 S34 T3N R10W S3 LS 65703 2026". No subsurface monument was set. I cut the top 10" off the found monument and placed it upside-down in the set 2" galvanized iron pipe, and placed the bottom 20" buried in ground on northerly side of set pipe. Set brass cap is 2" above concrete mixed in rocks.

REGISTERED
PROFESSIONAL
LAND SURVEYOR

VANCE SWENSON
OREGON
JULY 09, 2001
VANCE S. SWENSON
65703 LS

RENEWS 07-01-2026

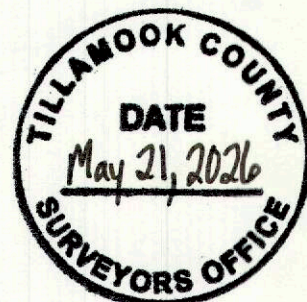

REFERENCES FOUND:

A 15" x 6' tall Hemlock stump N68°44'E 9.96 feet to face scribed "T4N R10W S34 BT", with a yellow metal location tag and nail in side-center. Reported as set in Record No. 5 at N68°E 10.47 feet to nail in side-center.

An approximately 20" diameter rotted Hemlock stump S34°E 13.5 feet to approximate upright position. Stump is tilted to the East and may be entirely displaced. Found portion of reverse scribed face in rotted remains. Reported as set in Record No. 1 at S42°E 13.9 feet.

The top of a 3 foot diameter boulder S81°34'W 11.0 feet to paint spot. Reported as "X" chiseled on top in Record No. 5 at S86°W 11.1 feet. No "X" was discernible in rough surface.

A 24" rotted Hemlock stump N33°30'W 9.7 feet to center, with portion of face scribed "BT" on ground facing corner. Reported as set in Record No. 1 at N31°W 8.6 feet.

A 12" x 4' tall Hemlock stump N18°41'W 13.63 feet to face scribed "T4N R10W S33 BT", with nail in side-center. Reported as set in Record No. 5 at N15°W 13.98 feet to nail in side-center.

A metal "T" fence post lying horizontal nearby. We reset it North 1.2 feet. Reported as set in Record No. 5 at North 1.0 feet.

Searched for GLO 36" Larch and its bearing trees at the Closing Corner Common to Sections 3 and 4, T3N, R10W at West 5.5 chains and found no evidence. Location is in old cat road bed in recent clearcut on steep and heavily disturbed hillside.

REFERENCES SET:

A 5/8" x 30" iron rod with a 2" aluminum cap stamped "Clatsop County Surveyor RM1" N55°36'48"E 633.61 feet, flush with ground in concrete.

A 30 mm copper disk stamped "Clatsop Co Sur" S82°15'37"E 16.03 feet, drilled and epoxied into north quadrant of 8 foot diameter boulder.

A 5/8" x 30" iron rod with a 2" aluminum cap stamped "Clatsop County Surveyor RM3" S52°59'43"W 234.73 feet, below surface 3" in concrete in northeasterly corner of pullout of gravel road.

An 18" Douglas Fir N00°09'21"W 239.57 feet to 3/4" brass washer stamped "LS 65703" in face scribed "T4N R10W S34 BT". Attached a yellow metal location tag.

An orange carsonite post South 1.1 feet.

Location is on steep slope aspect East in recent clearcut.

REGISTERED
PROFESSIONAL
LAND SURVEYOR

VANCE SWENSON
OREGON
JULY 09, 2001
VANCE S. SWENSON
65703 LS

RENEWS 07-01-2026

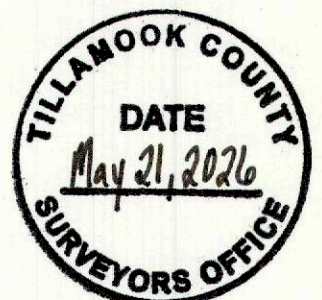

Basis of Bearings: Listed bearings are Geodetic. Listed distances are ground. Bearings were derived from GPS observations on nearby control points. State Plane Coordinates were determined by National Geodetic Survey Online Positioning User Service (OPUS) using direct static GPS observations on October 29, 2025, January 22, and February 3, 2026. A combination of continuously operating reference stations (CORS) P415, P446, P824, JIME and WDBN and were held for control. State Plane coordinates were established on the Standard Section Corner by field traverse from these control points.

STATE PLANE COORDINATES NAD 83[2011](EPOCH 2010) OREGON NORTH ZONE (3601) INT. FEET:

Standard Section Corner Common to Sections 33 and 34, Township 4 North, Range 10 West, W.M.:

NORTHING: 789883.15 EASTING: 7333633.98
LAT: 45°46'58.8409" LONG: -123°54'18.3594"
CONVERGENCE ANGLE: -2°24'53" COMBINED SCALE FACTOR: 0.9998788

County Surveyor Field Book 46, page 61, Clatsop County Survey Records.

Present: Vance Swenson, PLS 65703, County Surveyor
Jason Foose, PLS 94582, Deputy County Surveyor

Survey for Clatsop County by:

Vance S. Swenson, PLS 65703
1100 Olney Avenue
Astoria, OR 97103
Clatsop County Surveyor

REGISTERED
PROFESSIONAL
LAND SURVEYOR

VANCE SWENSON
OREGON
JULY 09, 2001
VANCE S. SWENSON
65703 LS

RENEWS 07-01-2026

